

The Scored Journal



ALOHA REGION

Issue: 167

Mar-Apr-May

President
Fred Weisberger
Phone: 254-0392

Vice-President
Harley Neff
Phone: 261-5519

Treasurer
Glen Houlton
Phone: 678-7266

Newsletter Editor
Victor Weisberger
Phone: 262-7117

Address Labels
Gary Wild



FEATURE STORY: 1926 Hispano-Suiza

The 1926 Hispano-Suiza model H6B belongs to member Jud Ihrig. Jud has owned this car for decades, having bought it in England. The car was recently shipped back to Hawaii from California where it underwent several years restoration. A new engine block was cast in France. In the photo the front fenders have not yet been mounted.

This model was so successful and advanced that it was built from 1919 to 1938 with few changes. It was a sensation when introduced at the 1919 Paris automobile show. It is an international car, the design is Swiss, the engine was made in France, and the body is English, built by Wayman. It is a padded fabric over wood framing. Wayman was known for custom building such bodies that were squeek-free and beautiful styling.

The engine is 402 cubic inches, six cylinder inline with a non-detachable head and overhead cam. This is a high performance engine which provides thrilling acceleration and speed.

It is equipped with four wheel servo assisted (power) brakes. A servo power take-off from the transmission is linked to the brake mechanism. This was a Hispano-Suiza patented design. The system was so good that

Reminder: Aloha Region AACA at the new car show, Mar 18, 19, & 20 the Waikiki Convention Center.

Antique car exhibit, members greet the public. Volunteer some time.

continued

Hispano-Suiza continued:

Rolls Royce paid royalties to use the brake system in their own cars.

Hispano-Suiza built airplane engines for World War I. Some of the airplane engine technology was carried over to this automobile engine.

Owner, Jud Ihrig, back to the camera in the front page photo, Harley Neff opening the back door. Hispano was in the price range of Rolls Royce.



Driver's Cockpit

The dashboard and instrument panel are so beautiful that they deserve their own photo. Airplane-like instruments placed in a black metal surround mated to a natural finished wood panel.

Above the dash is a screw mechanism to swing out the windshield for more ventilation. The car is right hand drive with both the shift lever and emergency brake gated. Below the dash on the interior firewall is an elegant fuse box with a glass window. To the left of the fuse box is the factory installed exhaust cut-out. Seats are upholstered in leather. Oh.....it all just takes your breath away.

ANTIQUE CAR 1st SAFETY

Under a policy change, antique cars shipped to Hawaii from other states must undergo a first safety inspection by "The City and County Motor Vehicle Control Section" (Reconstructed vehicle inspection office) located as follows:

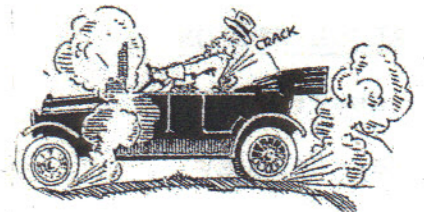

Reconstructed Vehicle Inspection
BY APPOINTMENT ONLY:

City & County Motor Vehicle Control Section
1112 Kapahulu Avenue
(under H-1 freeway, near Market City Shopping Center,
enter from Kapahulu Avenue)
Phone: 733-2542
Monday thru Friday 8:00 - 11:00 am, 12:00 - 3:00 pm
(Closed Saturdays, Sundays & Holidays)

CREDIT: Enlarged Hispano photos
by Bob Debone.

CREDIT: Newsletter printing,
Hank Gellert.



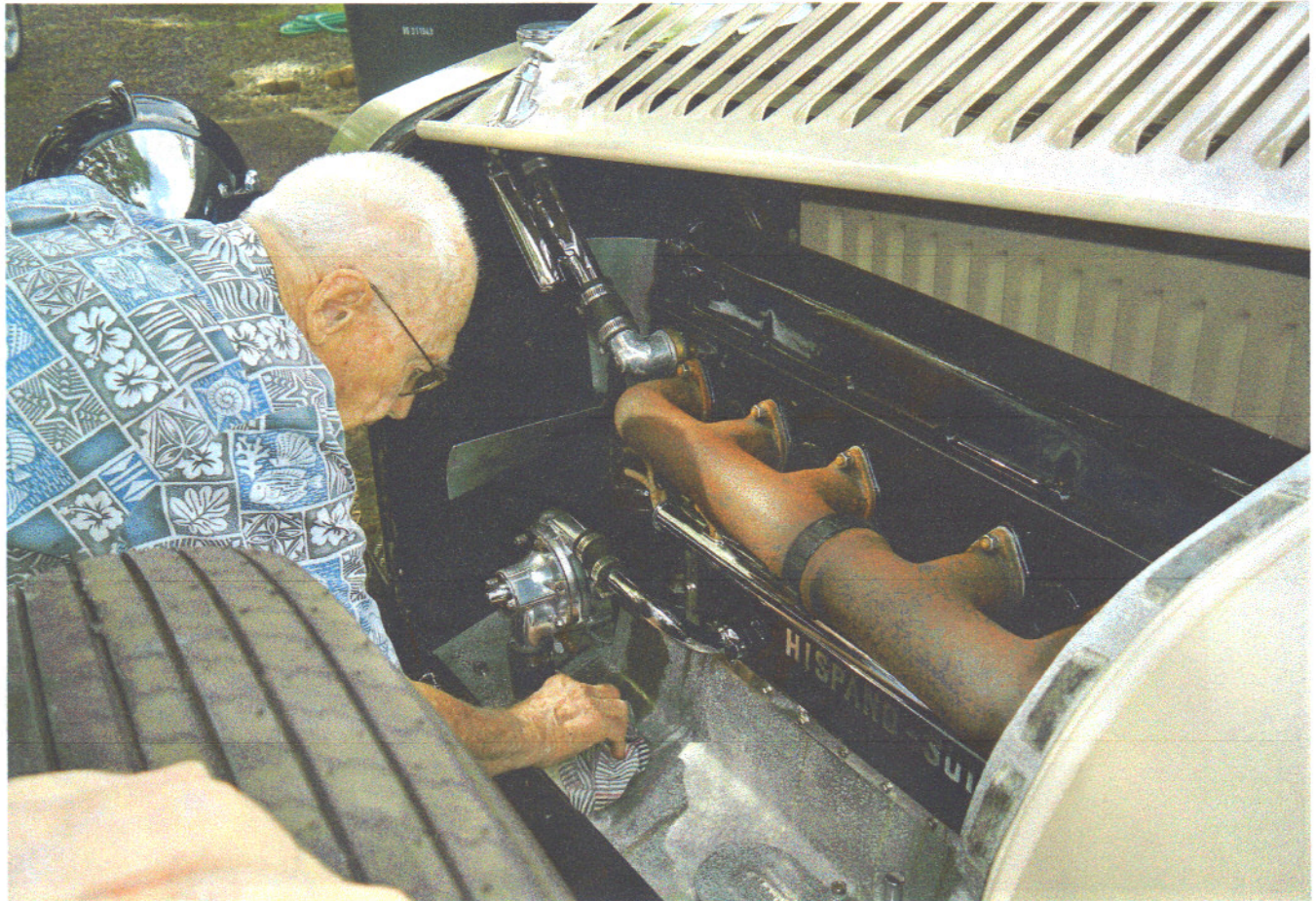
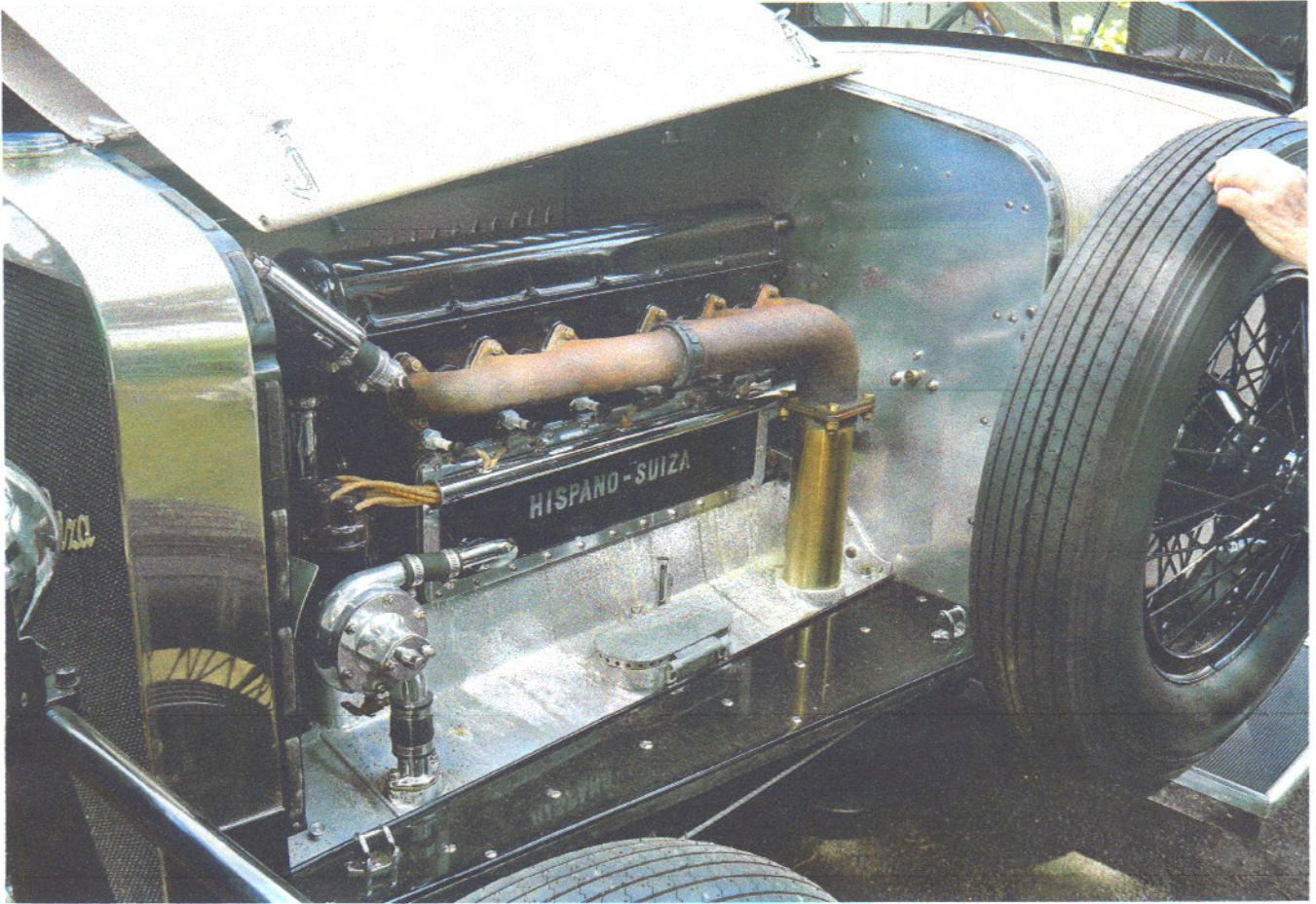

A later picture with the front fenders mounted, and the radiator ornament in place.

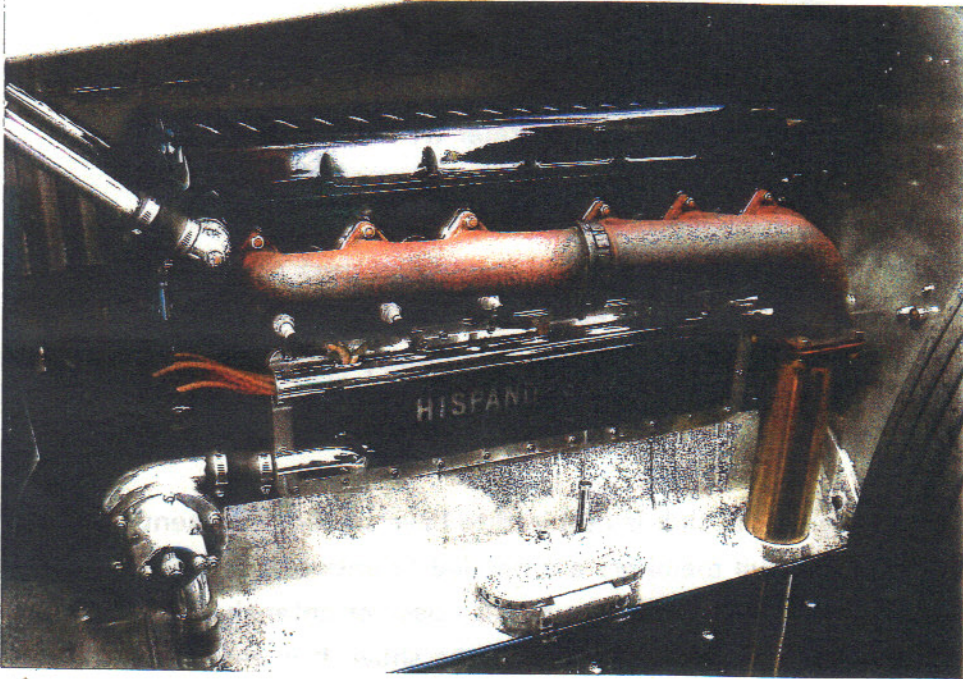

Engine view left side.

2011 AACA ALOHA REGION MEMBERSHIP RENEWAL

Name _____ **Dues: \$10.00**

Mailing Address _____

Phone Numbers (h) _____ (w) _____ (c) _____

Email: _____

AACA National Membership Number _____

Antique Cars Owned: _____

<u>Year</u>	<u>Make</u>	<u>Model</u>	<u>Body Style</u>	<u>Condition</u> (1=show to 6=parts)

Mail this form & \$10.00* to *Glen Houlton, 94-1142 Manino Place, Waipahu, HI 96707*
 *Please make checks payable to "Aloha Region".

ALOHA REGION INVITED TO THE 2011

FIRST HAWAIIAN AUTO SHOW

GREAT NEWS: The *Aloha Region* has been invited back to the *First Hawaiian Auto Show*. The show is March 18-20, Friday-Sunday—mark your calendars! This show is a great opportunity for club members to share their antique cars with the general public and to promote the *Aloha Region*. This is one of our “big events” for the year and it has led to new members joining the club. Since the economy is somewhat better, more new car dealers bought space, so we were lucky to be able to get space. Several local car clubs were not invited back this year, but we were able to secure over 2,500 sq. ft. on the main show floor. (See show map).

The club needs roughly 12 antique cars to display at the show. The show organizers, *Motor Trend* and the *Hawaii Automobile Dealers Association*, would prefer we have different cars displayed each year—with a preference towards older cars. The show cars need to be in (at least) very good condition and hopefully unusual and/or historically significant. They do not need to be running/driving cars because we should have at least one tow truck and trailer available. Show set-up will likely be after 12:00pm on Wednesday, March 16, and the cars need to be removed after 9:00pm on Sunday. If you are interested in displaying your antique car at the show, please call Fred at 254-0392 or Victor at 262-7117. (Also see the *Important Auto Show Requirements*)

We also need members to work at the show. The club is required to have someone present on the show floor every hour of the show. Club members are needed to answer questions about the cars, promote the club, and to make sure that the public does not enter the club space. Last year several members “worked” nearly every hour of the show. It is easy and fun—please come to the show and stay for a few hours.

Note: All club members can enter the show for free by going to the special exhibitor’s kiosk in the front and stating their name and club affiliation. We should also have some extra tickets for friends—during the show call Fred at 354-4644.

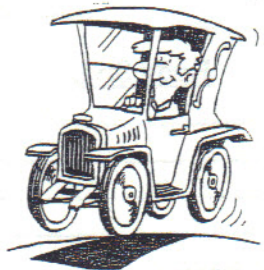

Important Auto Show Requirements:

- While on display, all show vehicles must have the positive battery cable disconnected and taped using UL approved plastic electrical tape.
- Failure to comply with directions from Show Management will lead to removal of vehicles from the show.
- Proof of insurance (as stated in the Feature Space Contract) or pre-approved by show management waiver must be provided to the show office upon move in.
- A display representative should be present during all public show hours, if possible.
- The vehicle gas level cannot exceed one-eighth (1/8) of a tank. All vehicles will be checked as they enter the convention center by security. They are very strict.
- If the gas cap can be opened from the outside of your vehicle, the vehicle must either have a locking gas cap or the cap must be taped. If the gas cap door can be locked from inside your car, then a locking gas cap is not necessary, but the standard inside gas cap must be taped.
- Please provide your own oil drip pans, if necessary.
- Cars using AC/DC converters must have the security system fuse disconnected to prevent the alarm from being accidentally set-off.
- Needed in advance, please provide a list of participant names so they may gain admittance into the auto show for free during all show hours.



**Friday, March 18
through
Sunday, March 20, 2011**

Location

Hawaii Convention Center

1801 Kalakaua Ave.
Honolulu, HI 96815
808.943.3500

Hours

Friday	12 noon - 10 pm
Saturday	10 am - 10 pm
Sunday	10 am - 7 pm

Area Display

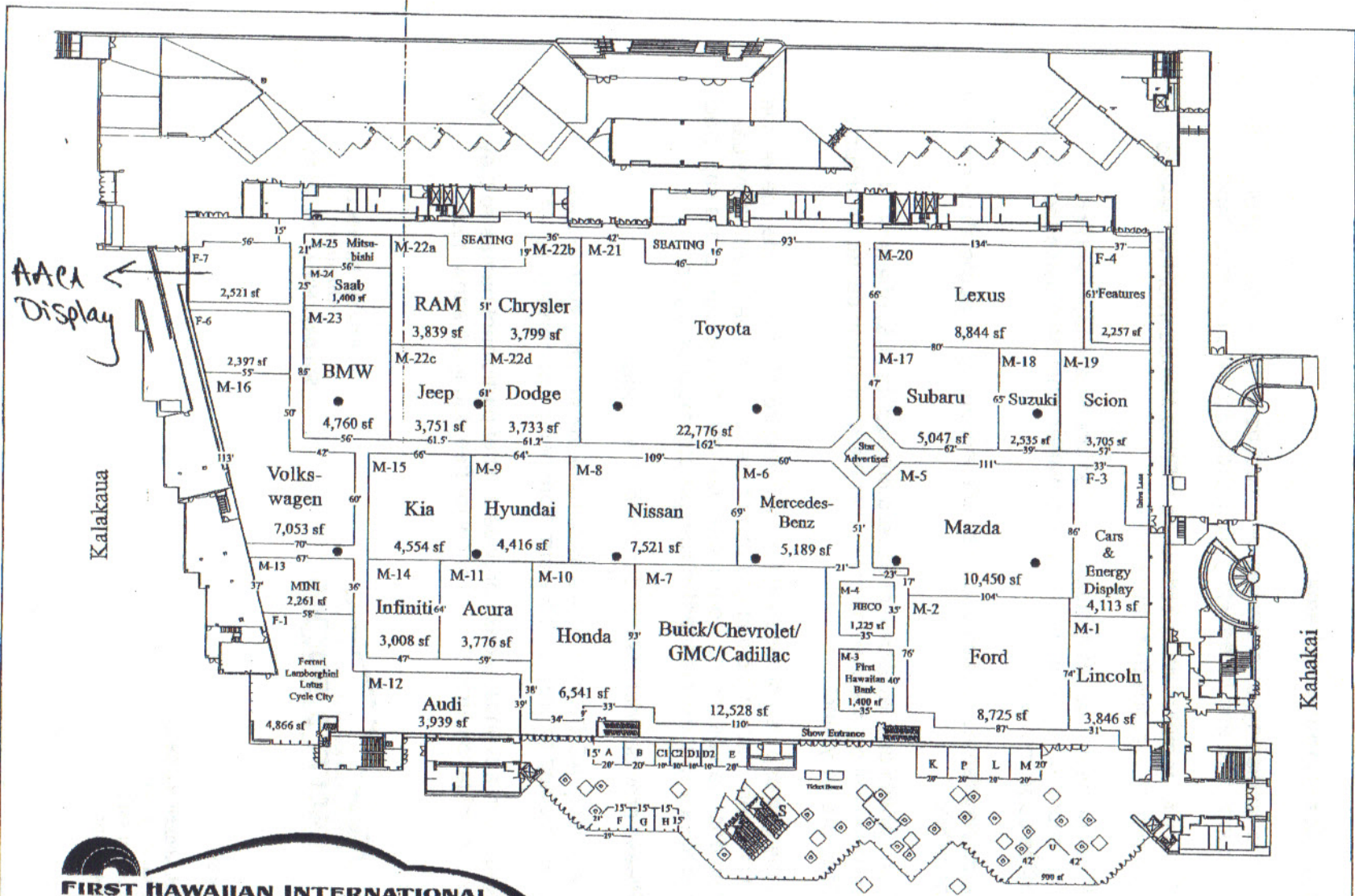

FIRST HAWAIIAN INTERNATIONAL 2011 AUTO SHOW

March 18 - 20, 2011
Hawaii Convention Center

<p><u>Exhibit Setbacks</u> on aisles: 1'-0" on exhibits: 2'-0"</p>	<p><u>Display Height Restrictions</u> All Spaces: 24'-0"</p>	<p>Design Date: Feb. 10, 2011</p>
--	--	-----------------------------------

The Aloha Mustang & Shelby Club of Hawaii
Presents
The 19th Annual
Mustang Madness All Ford Show

Sunday, March 27, 2011

9:00 AM to 4:00 PM

Mike McKenna's Windward Ford

725 Kailua Road

Kailua, Hawaii



RONALD McDONALD
HOUSE CHARITIES®
OF HAWAII



Vendors, crafts, food and over 60 of Hawaii's finest Fords!

Featuring the Rumble and Tower of Power Contests

A benefit for Ronald McDonald House Charities® of Hawaii



All show entries must be pre-registered.

There are limited spaces available in each award division.

No spectator admission charge.

Details at: www.alohamustang.com

or contact Harry Zisko: harryz@pobox.com Phone: 551-9517

Hawaii's largest and longest running all Ford Show

Sponsored by Mike McKenna's Windward Ford and Aloha Mustang & Shelby Club of Hawaii

FUTURE MEETS

Saturday, March 18, 19, and 20 NEW CAR SHOW, Aloha Region, AACA participates with an antique car exhibit, Waikiki Convention Center. See flyer

Sunday, March 27 MUSTANG MADNESS ALL FORDS SHOW, at Mike Mckenna's Windward Ford. See flyer.

Saturday, April 16 PRECISION MOTORS, Meet at 10:00AM. Bob Debone and staff will host a tour of the automotive machine shop. Bob's Peerless engine is being rebuilt here. This is the opportunity to ask questions about engine rebuilding. It has been about thirty years since the Aloha Region visited an automotive machine shop. The business is located next door to Sumida's body and fender shop.

No lunch will be served. The shop is small and there is no dining facility on the premises. Therefore, it is suggested that members select a nearby fast food restaurant for lunch and car talk. Within walking distance is a Jack in the Box, Arby's roast beef and Boston's Pizza.

There is street parking with meters and without meters two blocks away.



Joel Stallard
Master Machinest

Precision Motor Rebuilders
Automotive Machine Work
41 Hoolai Street Kailua, HI 96734

261-0883
Fax 262-4414

Across from Agnes' Bake Shop

SATURDAY, MAY 21 FRED WEISBERGER'S GARAGE, Meet 10:00AM, 90 Aikahi Loop, Kailua. Street parking and best spots for antique cars. Fred will serve a picnic lunch. Wives and girlfriends and club prospects are invited.

SATURDAY, JUNE 18 PODIUM RACEWAY, Meet at 10:00AM, Barbers Point Naval Air Station, 91-1085 Lexington Street, Bldg 1844. This is an indoor raceway with a serpentine course with small electric race cars for rent to the public. Fourteen laps for \$20.00, instruction and safety helmets furnished. Spectators are welcome too. No admission charge to watch. This is a new venture which occupies the old commsary building, about the size of a bowling alley. The lounge area faces the track for a good view of the fast action. Vending machines with soda and fruit juice. Outside fast food is permitted and there is a Subway in the building just behind the raceway building. Comfortable furniture in the spectator area, everything is new, Plenty of free parking. Naval outdoor aviation museum is at the end of Lexington street. Shoes required to drive a racing car.



Warren Cole 808 729-0905

91-1085 Lexington St. - Bldg. 1844, Kapolei, HI 96707
Mail to: PO Box 75267, Kapolei, HI 96707

warren@podiumraceway.com

The Scored Journal

Aloha Region
Antique Automobile Club of America

162 Kaha Street
Kailua, Hawaii 96734

FIRST CLASS MAIL